



Autodesk Academic Certification Program Overview

Autodesk

Academic Certification Information

Program Overview

- Benefits for Schools and Students

Program Details

- 2009 and 2010 Academic Certification Solutions
- Student requirements, Grading & Outcomes
- Center application and ordering process

Program Implementation

- Certification Center Requirements
- Next Steps

Program Benefits for Schools

- Provides industry level exams at an affordable academic price.
- Final result for students is the same credential earned by working professionals.
- Exams can be delivered in your school if you meet minimum requirements.
- Certification exam objectives map to select national standards.
- Assessment test, practice tests, exam guides and training guides available for preparation.
- Training guides cover 100% of test objectives.
- Student score report maps missed items to specific lessons in guide.
- Free certification exams to teachers at schools who become testing sites.



Program Benefits for Students

- Provides industry level credential at an affordable academic price.
- The final result is the same credential earned by working professionals.
- Allows continuous skill building – can build on certification from school when they leave, or update to newer release.
- Students differentiate themselves in a competitive job market.
- Students can add value to their resume by leveraging the Autodesk brand.
- Assessment tests, practice tests and Autodesk Official Learning Guides available for preparation.
- Student score report maps back to lessons in Autodesk Guides so students can review missed areas.

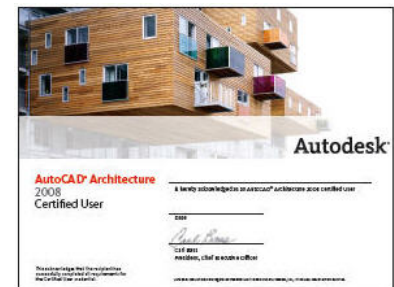

Autodesk Certificates and Logos for Students



AutoCAD®
2010

In recognition of their commitment to achieving professional excellence, this certifies that

This number certifies that the recipient has successfully completed all program requirements.

Autodesk

has successfully completed

Date



AutoCAD®
Civil 3D® 2010

In recognition of their commitment to achieving professional excellence, this certifies that

has successfully completed



Autodesk Inventor®
2010

In recognition of their commitment to achieving professional excellence, this certifies that

has successfully completed the program requirements of

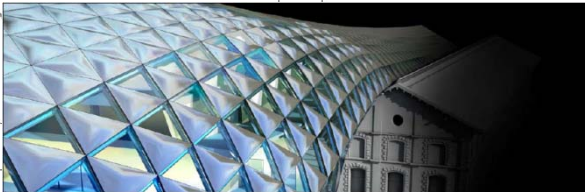

Autodesk Revit®
Architecture 2010

In recognition of their commitment to achieving professional excellence, this certifies that

This number certifies that the recipient has successfully completed all program requirements.

Autodesk

Autodesk and Revit are registered trademarks or trademarks of Autodesk, Inc., in the United States and/or other countries. Autodesk Inventor and AutoCAD are registered trademarks of Autodesk, Inc. in the United States and/or other countries.

Date

Carl Bass

Carl Bass
President, Chief Executive Officer



Autodesk 3ds Max®
Design 2010

In recognition of their commitment to achieving professional excellence, this certifies that

This number certifies that the recipient has successfully completed all program requirements.

Autodesk

Autodesk and 3ds Max are registered trademarks or trademarks of Autodesk, Inc., in the United States and/or other countries. Autodesk Inventor and AutoCAD are registered trademarks of Autodesk, Inc. in the United States and/or other countries.

Date

Carl Bass

Carl Bass
President, Chief Executive Officer

Carl Bass
Carl Bass
President, Chief Executive Officer

coming soon...

AutoCAD®
2010

Certified Associate

Autodesk Revit®
Architecture 2010

Certified Professional

AutoCAD®
Civil 3D® 2010

Certified Associate

Autodesk Inventor®
2010

Certified Professional

Au

Autodesk Revit®
Architecture 2010

Certified Associate

Autodesk

AutoCAD®
Civil 3D® 2010

Certified Professional

Autodesk Inventor®
2010

Certified Associate

Au

AutoCAD®
2010

Certified Professional

Autodesk 3ds Max®
Design 2010

Certified Associate

Autodesk 3ds Max®
Design 2010

Certified Professional

Autodesk

Available Certifications

- AutoCAD Architecture 2009 only
- AutoCAD 2009, 2010
- Autodesk Revit Architecture 2009, 2010
- AutoCAD Civil 3D 2009, 2010
- Autodesk Inventor 2009, 2010
- Autodesk 3ds Max Design 2010

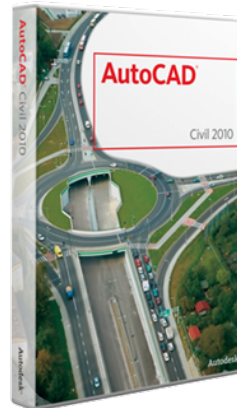
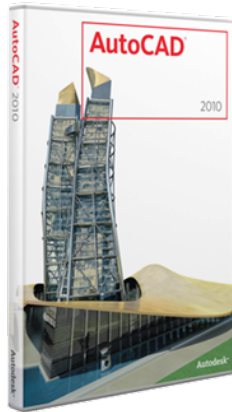

coming soon...

Certification Solutions for Schools

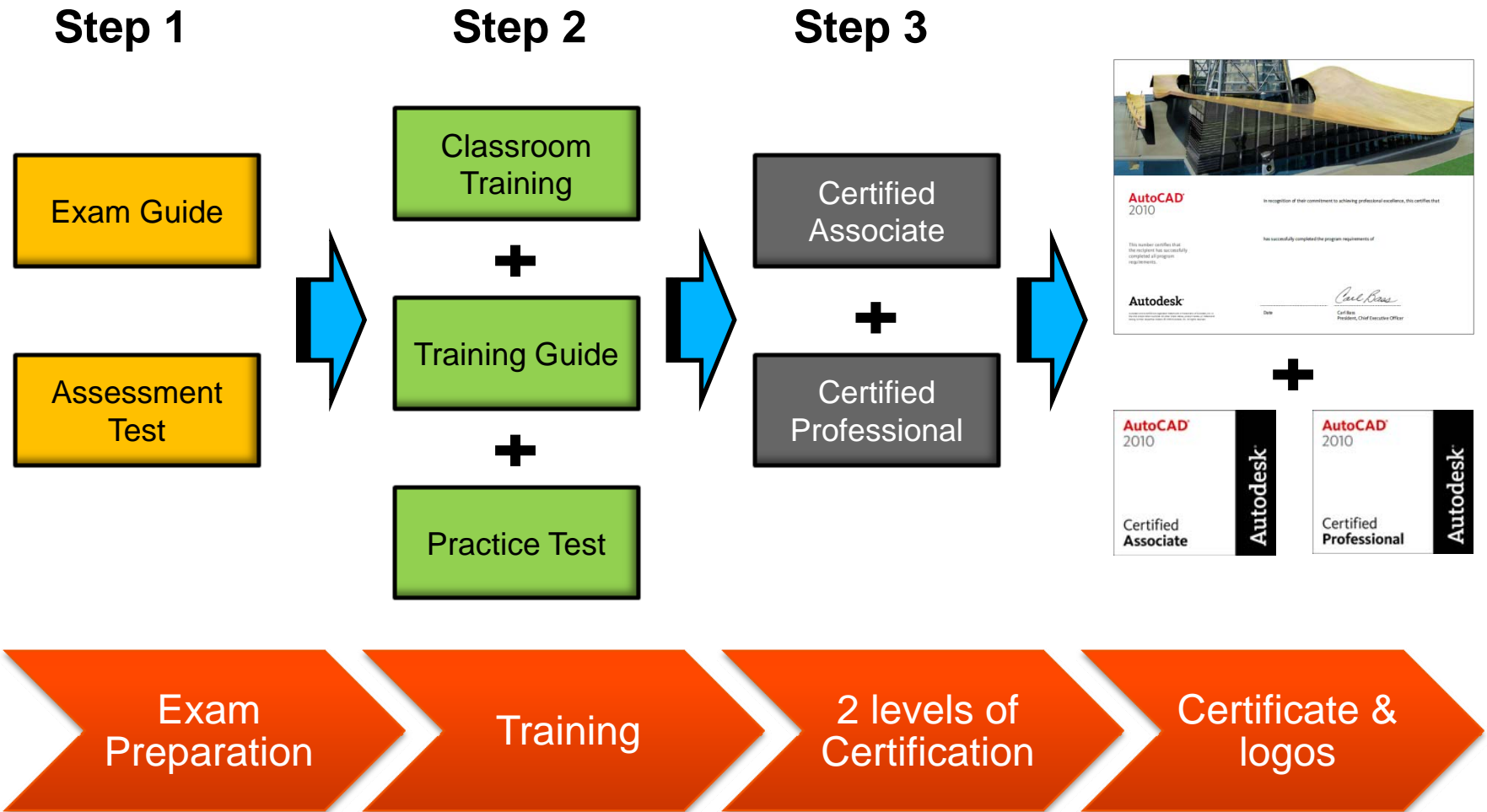

Certification Exam Design

Certified Associate

- Multiple Choice
- 60 minutes
- 30 questions
- ADA adjustment available
- Certification available

Certified Professional

- Performance based
- 90 minutes
- 20 questions
- ADA adjustment available
- Certification available

Preparation Tests

Assessment

- Multiple Choice
- 90 minutes (start/stop)
- 50-70 questions
- No pass/fail
- Feedback including missed questions/correct answers
- Non-proctored
- No certification available

Practice

- Performance based
- 135 minutes (start/stop)
- 20 questions
- No pass/fail
- Feedback similar to cert exams – mapped back to Learning Guides
- Non-proctored
- No certification available

Newly Designed Exam Guides

Exam Guides include detailed exam preparation information, exam sections and objectives, sample items, and test taking strategies.



Exam Delivery

Autodesk Online Testing System

- Autodesk Online hosted by Internet Testing Systems.
- Available 24/7 via the web.
- Certification exams require proctor.
- Allows for quick purchase and delivery (with credit card).
- No fee for schools to join, schools must meet minimum requirements.
- Testing components are downloaded from the testing system.



Academic Pricing

Solution	Secondary	Post secondary
2009 & 2010 Associate	\$25	\$25
2009 & 2010 Professional	\$50	\$50
2009 Assessment	\$15	\$15
2009 Prof practice test	\$15	\$25
2009 & 2010 Training Guides*	~ \$80	~ \$80

Certification Center Technical Requirements

Application Software

- All Autodesk performance based certification exams require the Autodesk application for testing.
 - Release specific Autodesk application (i.e. AutoCAD 2009)
 - No AutoCAD LT in place of AutoCAD
 - No bundled products (Cannot use the AutoCAD included in Mechanical Desktop)
 - Application proficiency, assessment exams, and 2009 Associate level exams do not require Autodesk applications.

Browser

- Microsoft Internet Explorer V5.5 or better

Operating System

- MS Windows . XP, Vista

Internet Connection

- Broadband connection (DSL, Cable, or T1) recommended

Certification Center Requirements

- Certification Center must be an academic institution.
- Certification Center must accept the on-line Testing Center Agreement.
- Certification Center must provide a proctor for all testing.
- Certification Center must have licensed software for each station to be used when the testing requires the software.
- Certification Center must meet minimum hardware/software requirements.
- Testing Site Administrator determines test session availability and location.
- There is no fee to join, minimums apply.

Application Process, Purchasing Exams and Training Guides

- Application Process
 - Schools should contact their Autodesk Value Added Reseller (AVAR) to learn more about the requirements. www.autodesk.com/avar
- Purchasing Exams
 - Schools who become certification centers can purchase exams directly from their AVAR.
- Purchasing Training Guides
 - Schools may purchase Autodesk Authorized Training Guides directly from their AVAR.



Student Testing Details

- Students are prompted before testing to fill out a profile form with demographic data. (no pre-registration required)
 - Create user name and password
 - Allows access to score reports, e-certificate, and logos – 24/7
- Proctors will start the test and answer questions about the testing system.
- Students take a tutorial to familiarize themselves with the testing system. This does not take time away from the test.
- Students can take a break, and re-start their test.



Grading and Outcomes

Results

- Results and status are listed on the score report students receive when they complete an examination. Can be printed and accessed again.
- Feedback includes missed items with mapping to Learning Guide lessons.
- Schools can print and review results.

Electronic Certificate

- When they pass, students gain access to an electronic certificate in PDF format. This e-Certificate includes a unique serial number that authenticates the certificate as valid. Certificate and score report can be reprinted anywhere, anytime.

Right to use Autodesk Certification Logo

Listing in Certified Professionals Database (optional)

- Display certification status to employers



Are You Ready for Certification?

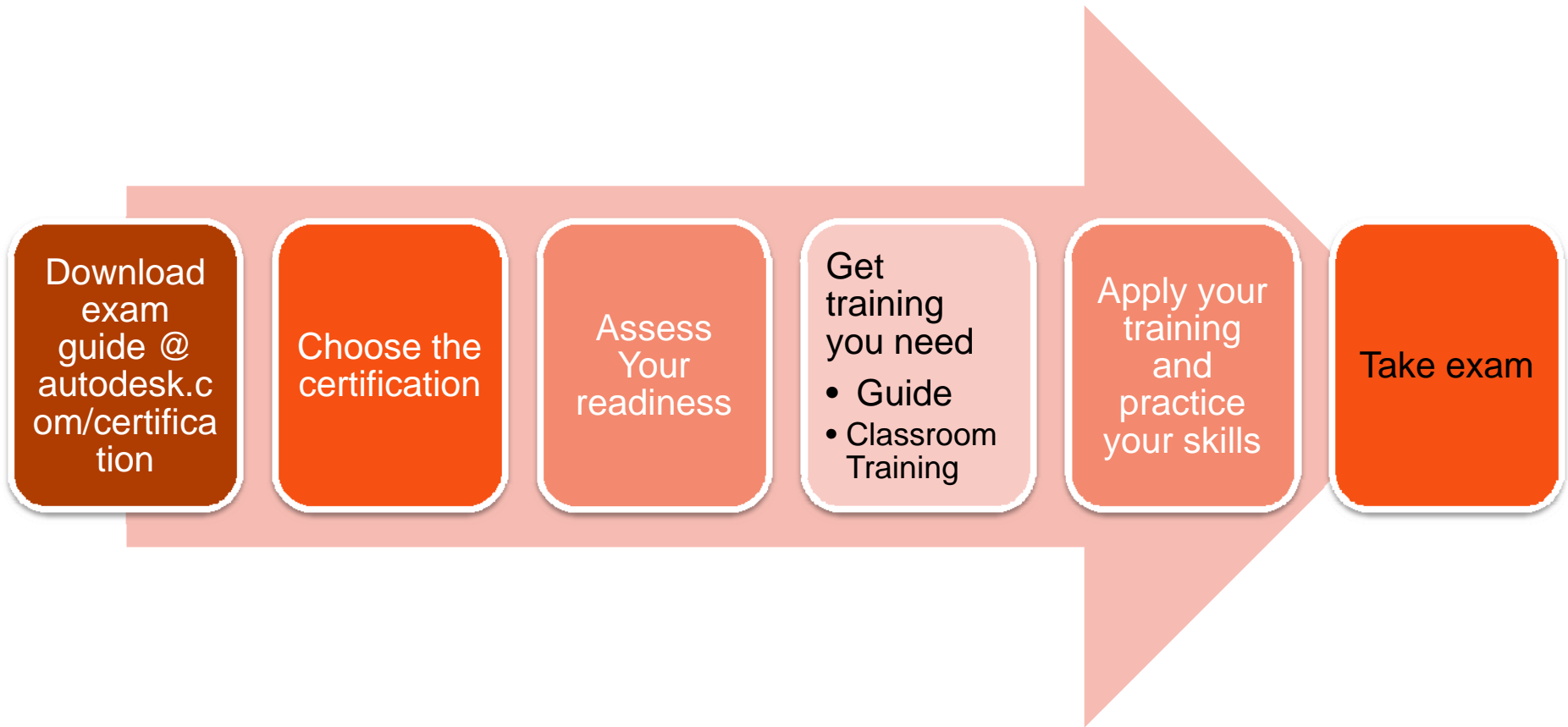

For More Information

Schools should contact their Autodesk Value Added Reseller (AVAR) to learn more about the requirements. www.autodesk.com/avar

For more information about Autodesk Certification www.autodesk.com/certification